

## GM60 - EMBOUT MÂLE SÉRIE MINI

### Caractéristiques techniques

Fluide:	Air comprimé
Pression d'utilisation:	0 à 12 bar
Débit de l'air:	1100 l/min
Matériaux:	Laiton et acier
Type de filetage:	BSPP cylindrique de 1/8" à 1/4"

### Technical data

Fluid:	Compressed air
Working pressure:	0 to 12 bar
Air flow:	1100 l/min
Materials:	Brass and steel
Thread types:	BSPP cylindrical from 1/8" to 1/4"

### Technischen Daten

Fluid:	Druckluft
Betriebsdruck:	0 bis 12 bar
Luftstrom:	1100 l/min
Werkstoffen:	Messing und Stahl
Gewinde type:	BSPP zylindrisch von 1/8" bis 1/4"

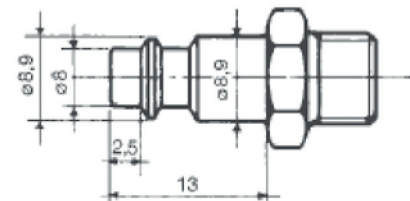

Diamètre interne d. 5,0 mm  
Internal hole d. 5,0 mm

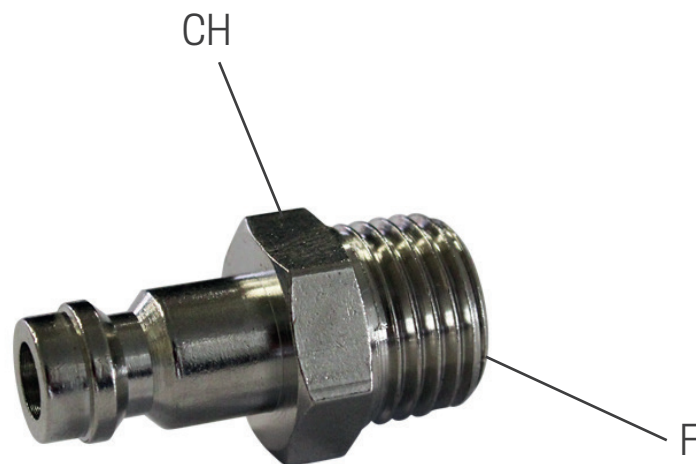

Code	F"	L	CH	
GM600018	G1/8	26	12	10
GM600014	G1/4	28,5	14	10